



# Galaxy Homes



**REGISTERED OFFICE:**

NDM-2, C-807, NETAJI SUBHASH PALCE, PITAMPURA, NEW DELHI-110034

**HRERA REGISTRATION NO:**

HRERA-PKL-RWR-478-2023 DATED: 19/07/2023

**CIN NO. -** U45400DL2007PTC165291

**COMPANY NAME -** Galaxy Realcon Pvt. Ltd.

**PAN NO. -** AADCG0059R

**WEBSITE -** [www.galaxyhomesrewari.com](http://www.galaxyhomesrewari.com)

**SITE ADDRESS:**

Galaxy Homes, Bambar & Sangwari, Sector - 33, Rewari, Haryana

All information, images and visuals, drawings, plans or sketches shown in this brochure are only an architect's impression, representative images or artistic renderings and not to scale. Nothing contained herein intends to constitute a legal offer and does not form part of any legally binding agreement and/or commitment of any nature. The Company endeavours to keep the information up to date and correct. Recipients/viewers are advised to exercise their discretion in relying on the information shown/provided and are requested to verify all the details including area, amenities, services, terms of sales and payments and other relevant terms independently with the Sales Team/Company, have thorough understanding of the same and take appropriate advice prior to concluding any decision for buying any Unit(s) in the Project.

HRERA-PKL-RWR-478-2023 DATED: 19/07/2023





All information, images and visuals, drawings, plans and sketches shown in this brochure are only an architect's impression, representative images or artistic renderings and not to scale.

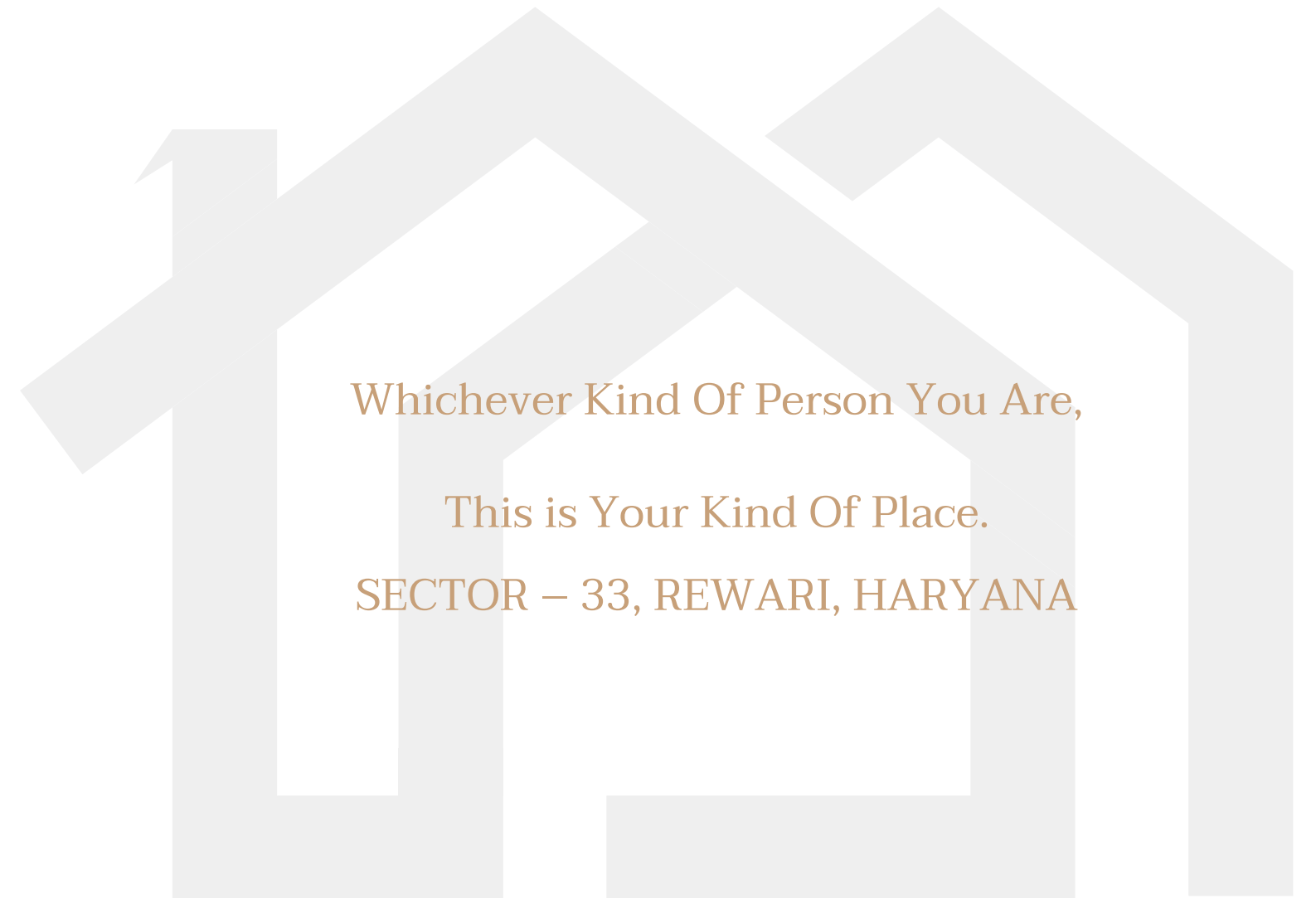

Whichever Kind Of Person You Are,  
This is Your Kind Of Place.  
SECTOR – 33, REWARI, HARYANA





Galaxy Realcon Pvt. Ltd. is a project under Deen Dayal Plots Yojna, spread in 10 Acres and surrounded with lush green peaceful environment. Located on Sangwari, Sector – 33, Rewari Galaxy Realcon Pvt. Ltd. project has its unique specifications. 1st time in the history of Deen Dayal Plots Yojna, we've Club House provision at our site which will create a cheerful and conversative ambience.

- Have a look over the key features of our project :-
- Gated Society with CCTV Surveillance.
- Entrance from 30 meter wide main road
- Roadside Shopping Complex and badminton court, open gym and kids play area.

# A 15 YEAR LEGACY OF TRUST

Galaxy Realcon Pvt. Ltd. stands as a beacon of excellence in the real estate industry in Delhi. With a legacy spanning over 15 years, we have been dedicated to transforming visions into reality by developing premier residential plots that cater to diverse needs and aspirations. Our unwavering commitment to quality, innovation, and customer satisfaction has established us as a trusted name in the real estate sector.

All information, images and visuals, drawings, plans and sketches shown in this brochure are only an architect's impression, representative images or artistic renderings and not to scale.





## LOAN APPROVED BY SBI

We understand that buying a plot is a significant investment, and we are here to help make it as smooth as possible. Through our partnership with the State Bank of India (SBI), we offer our customers the convenience of securing home loans at competitive rates. Our team will assist you through the entire loan approval process, ensuring you have all the support you need to make your dream home a reality.







## RESIDENTIAL PLOTS AT GALAXY HOMES

At Galaxy Realcon, we prioritize excellence in every project. From the initial planning to the final execution, our team of experienced professionals ensures that every residential plot meets the highest standards of quality and durability.



All information, images and visuals, drawings, plans and sketches shown in this brochure are only an architect's impression, representative images or artistic renderings and not to scale.





All information, images and visuals, drawings, plans and sketches shown in this brochure are only an architect's impression, representative images or artistic renderings and not to scale.



## Innovative Solutions

We continually innovate to offer modern and functional living spaces that cater to the evolving needs of our customers.





**GIVE YOUR LOVED ONES  
A GIFT OF HEALTHY NATURE**

Enter a scenery where modern architecture  
shakes hands with perfectly sculpted landscaping.



All information, images and visuals, drawings, plans and sketches shown in this brochure are only an architect's impression, representative images or artistic renderings and not to scale.





All information, images and visuals, drawings, plans and sketches shown in this brochure are only an architect's impression, representative images or artistic renderings and not to scale.



## LET YOUR DREAMS UNFOLD

Live the modern luxury life  
amidst a verdant neighbourhood.





## DESIGN

Residential plots  
with greenery

## GREENERY

Verdant landscape  
with tree-lined avenues

## CONNECTIVITY

Galaxy Homes is well-connected to two  
major highways (NH - 71 & NH - 11)

## SECURITY

Gated  
community

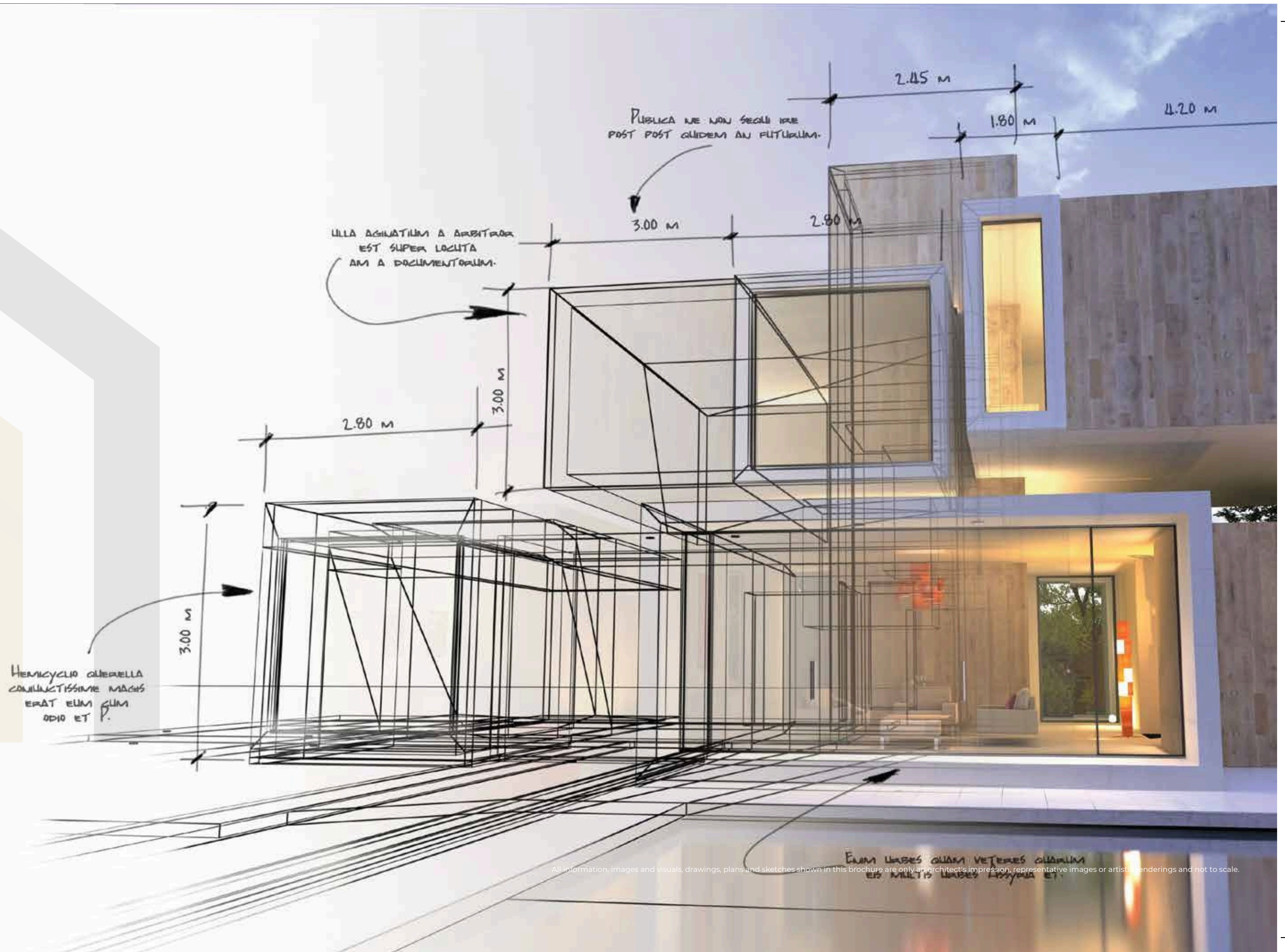







# KEY HIGHLIGHTS



ATTRACTIVE  
PLOT SIZE



SECURE GATE  
COMMUNITY



KIDS PLAY AREA



DESIGNER LIGHT POLES  
WITH ELECTRIC SAVING  
LED LAMPS



SMART DRIP AND  
SPRINKLER IRRIGATION  
SYSTEM



DECORATIVE  
PAVER ROAD



ENVIRONMENT-FRIENDLY  
GRASS CONCRETE  
PAVER SIDE WALKS



SEWAGE TREATMENT  
PLANT



## PLANNED FOR BLISS

The community has been planned with holistic amenities to make every day here safer and more joyful. Further, a host of sustainable practices help us give back to nature, while giving the residents their best life.



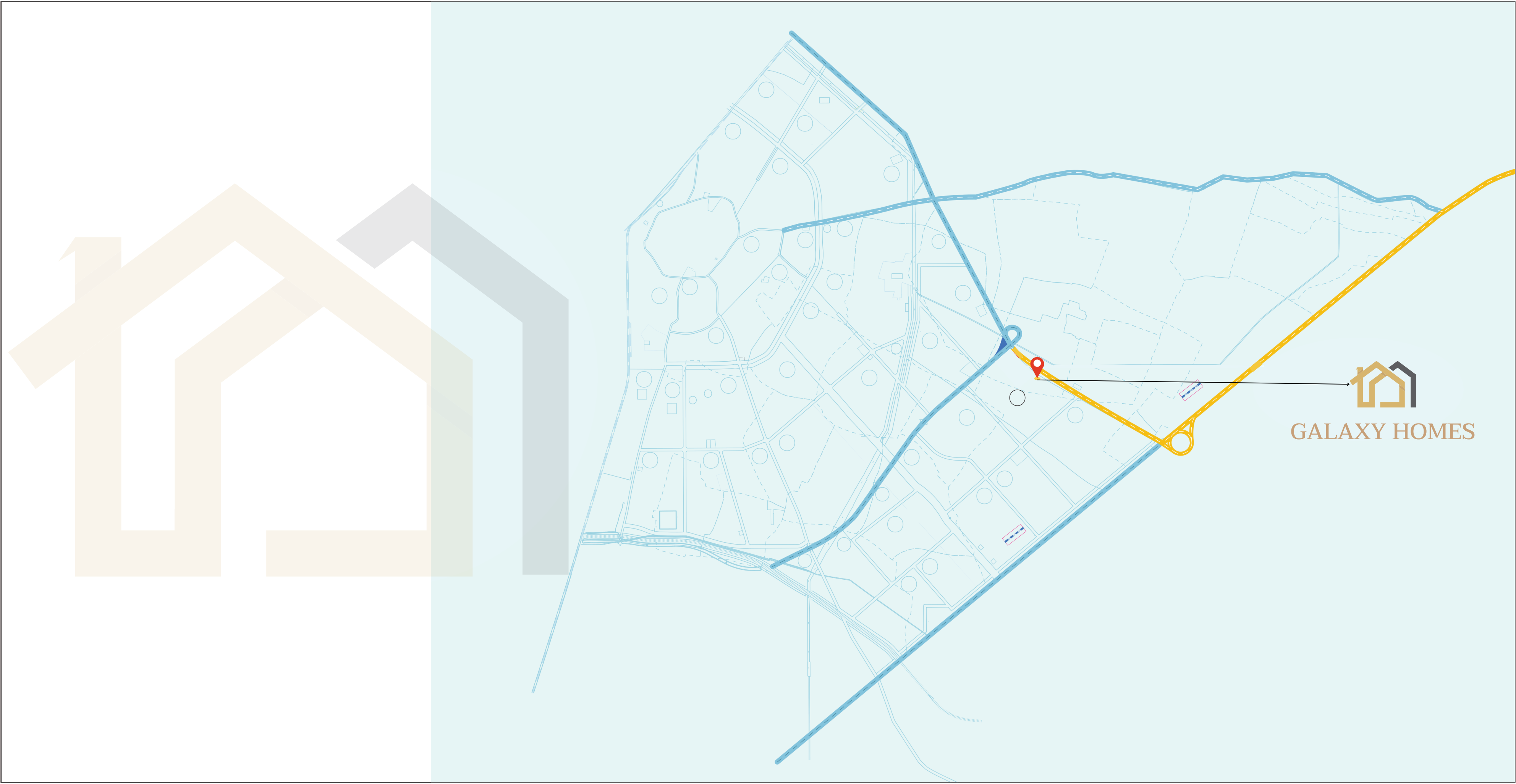

  
GALAXY HOMES